

Healthcare

HAWORTH®

DEPARTMENT OF DEFENSE (DOD)
Joint Schedule Numbers (JSNs)

Administrative Typicals E0000 – E0199

E0042



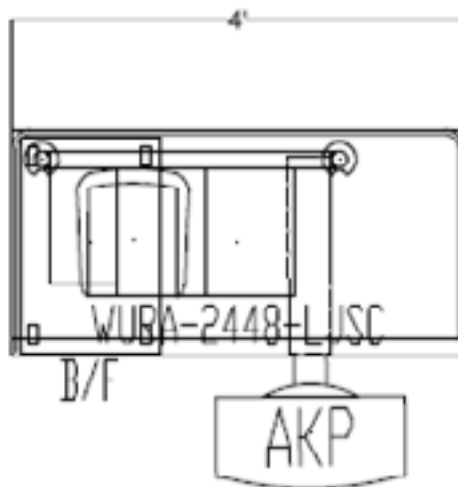
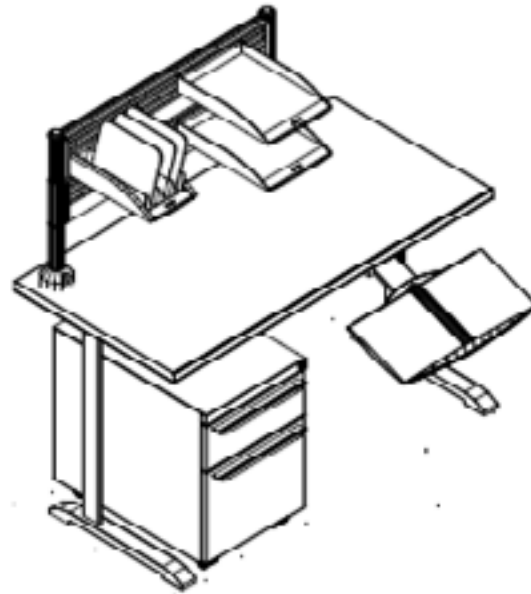

QTY	DESCRIPTION
1	Tool Rail
2	Paper Tray
1	Diagonal Tray
1	Freestanding Worksurface
1	Adjustable Keyboard Tray
1	Mobile Pedestal, Box/File

Department of Defense

Administrative Typicals

E0042

E0045



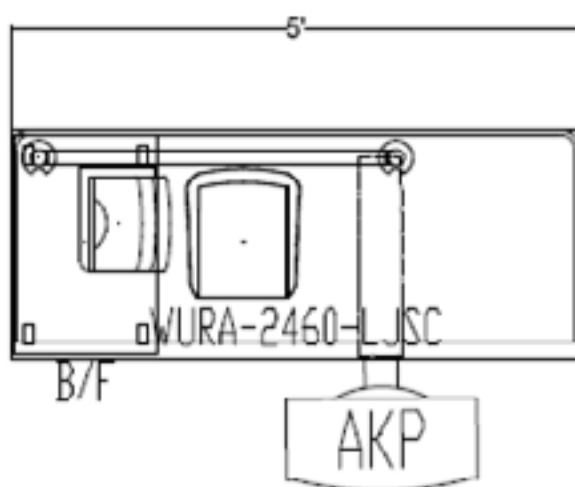
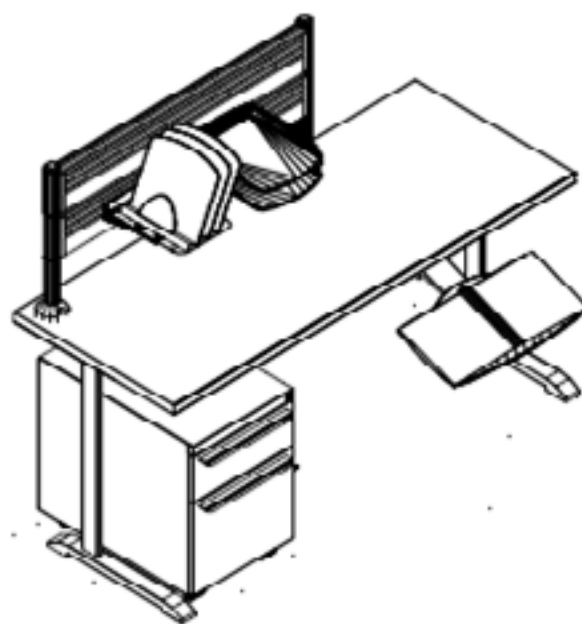

<u>QTY</u>	<u>DESCRIPTION</u>
1	Tool Rail
2	Paper Tray
1	Diagonal Tray
1	Freestanding Worksurface
1	Adjustable Keyboard Tray
1	Mobile Pedestal, Box/File

Department of Defense

Administrative Typicals

E0045

E0048



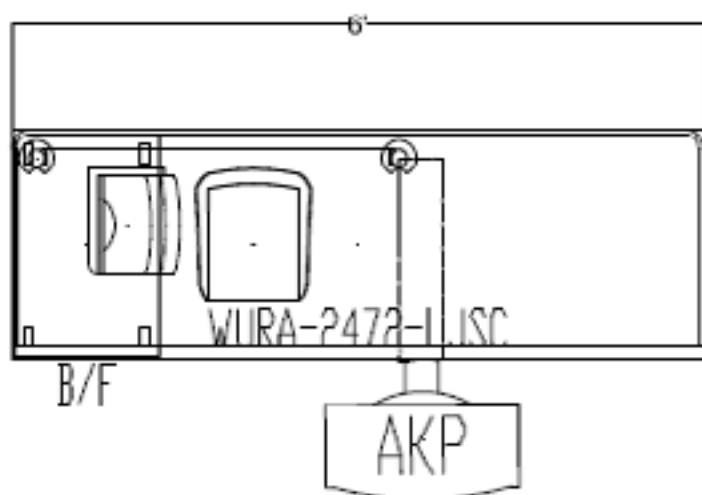
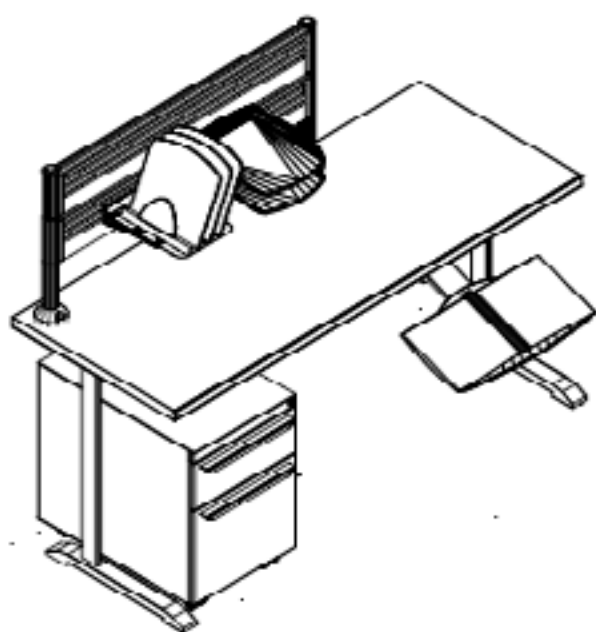

QTY	DESCRIPTION
1	Tool Rail
2	Paper Tray
1	Diagonal Tray
1	Freestanding Worksurface
1	Adjustable Keyboard Tray
1	Mobile Pedestal, Box/File

Department of Defense
Administrative Typicals

E0048

E0051



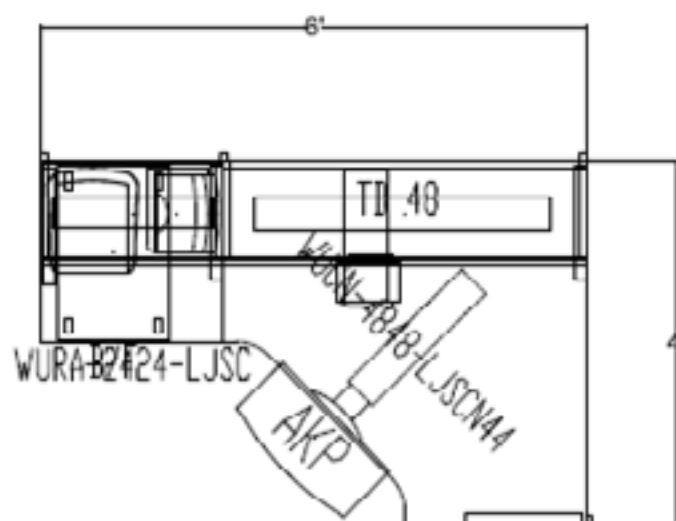
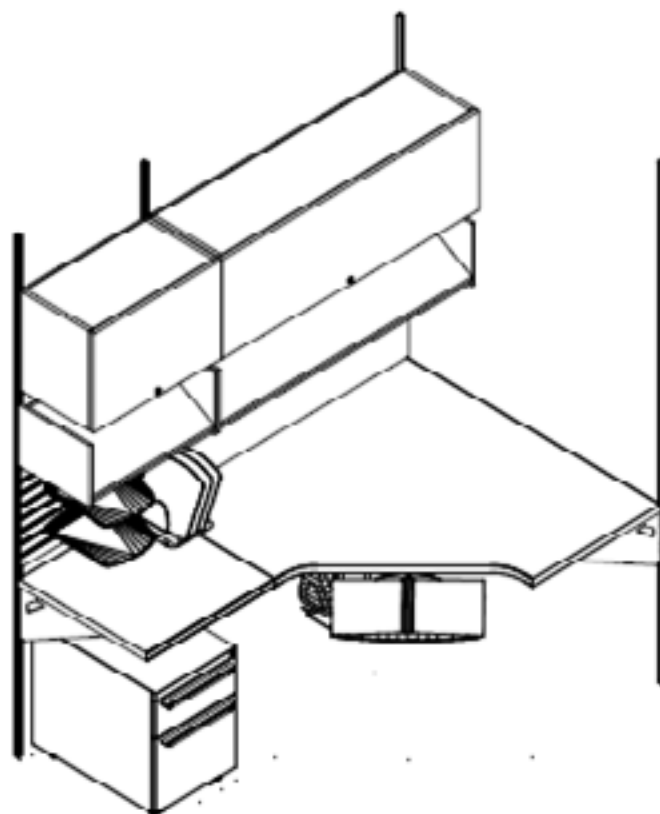

QTY	DESCRIPTION
4	Vertical Hanging Strips
2	Lockable Flipper Unit
2	Shelf, Storage/Display
2	Light
1	Tackboard
1	Slat Wall
2	Paper Tray
1	Diagonal Tray
1	Cantilevered Work Surface
1	Cantilevered Corner Work Surface
1	Mobile Pedestal, Box/File
1	Adjustable Keyboard Tray
1	CPU Holder

Department of Defense

Administrative Typicals

E0051



E0054

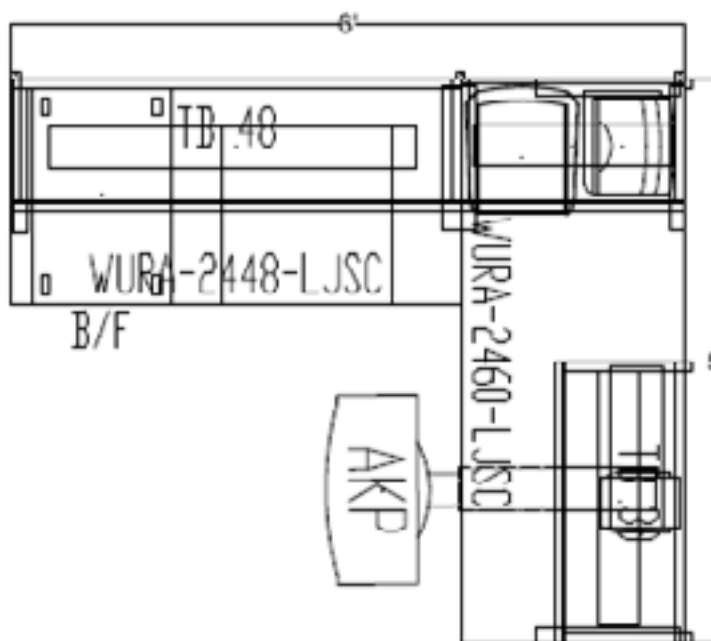
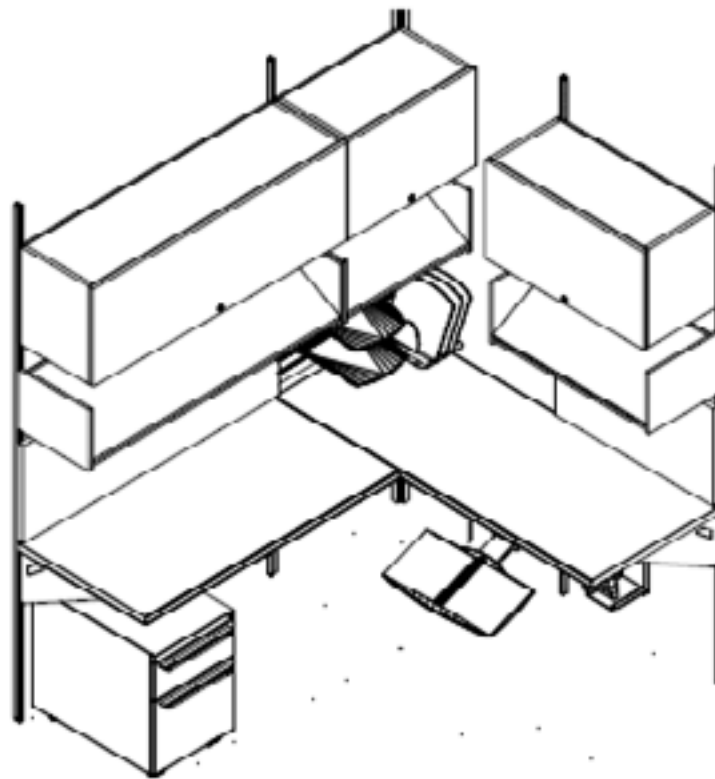

QTY	DESCRIPTION
6	Vertical Hanging Strips
3	Lockable Flipper Unit
3	Shelf, Storage/Display
3	Light
2	Tackboard
1	Slat Wall
2	Paper Tray
1	Diagonal Tray
2	Cantilevered Work Surface
1	Adjustable Keyboard Tray
1	Mobile Pedestal, Box/File
1	Pencil Drawer
1	CPU Holder

Department of Defense

Administrative Typicals

E0054

E0057



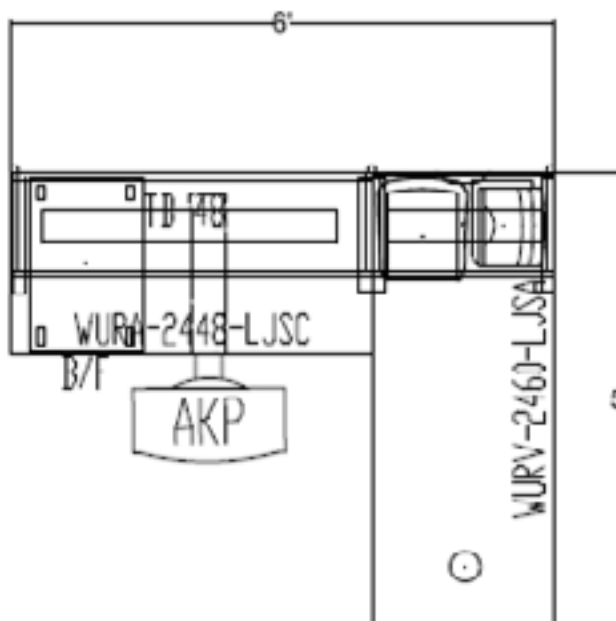
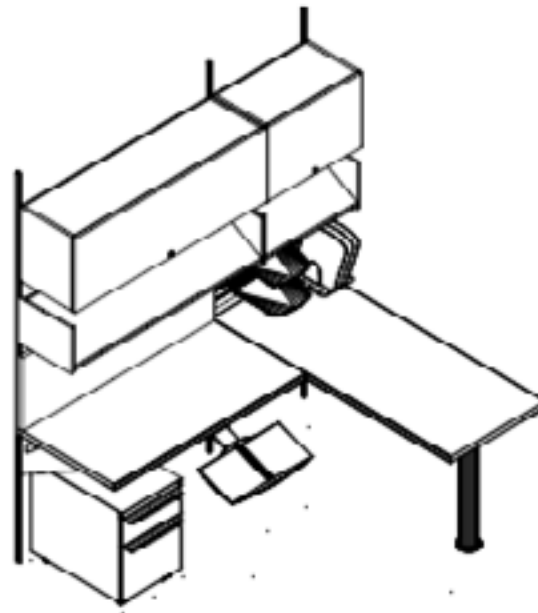

QTY	DESCRIPTION
3	Vertical Hanging Strips
2	Lockable Flipper Unit
2	Shelf, Storage/Display
2	Light
1	Tackboard
1	Slat Wall
2	Paper Tray
1	Diagonal Tray
2	Cantilevered Work Surface
1	Adjustable Keyboard Tray
1	Mobile Pedestal, Box/File

Department of Defense

Administrative Typicals

E0057

E0060



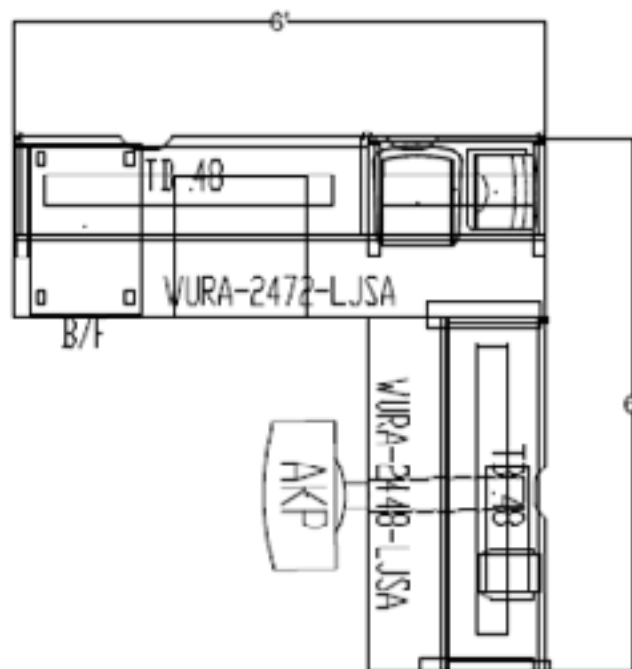
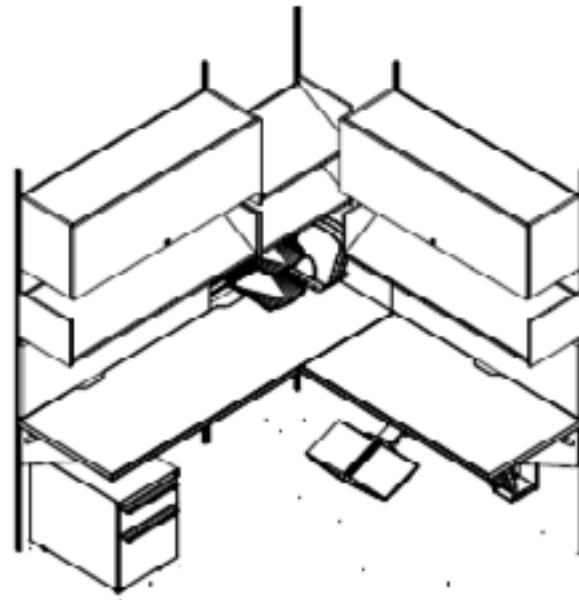

QTY	DESCRIPTION
5	Vertical Hanging Strips
2	Lockable Flipper Unit
4	Shelf, Storage/Display
3	Light
2	Tackboard
1	Slat Wall
2	Paper Tray
1	Diagonal Tray
2	Cantilevered Work Surface
1	Adjustable Keyboard Tray
1	Mobile Pedestal, Box/File
1	Pencil Drawer
1	CPU Holder

Department of Defense

Administrative Typicals

E0060



E0063

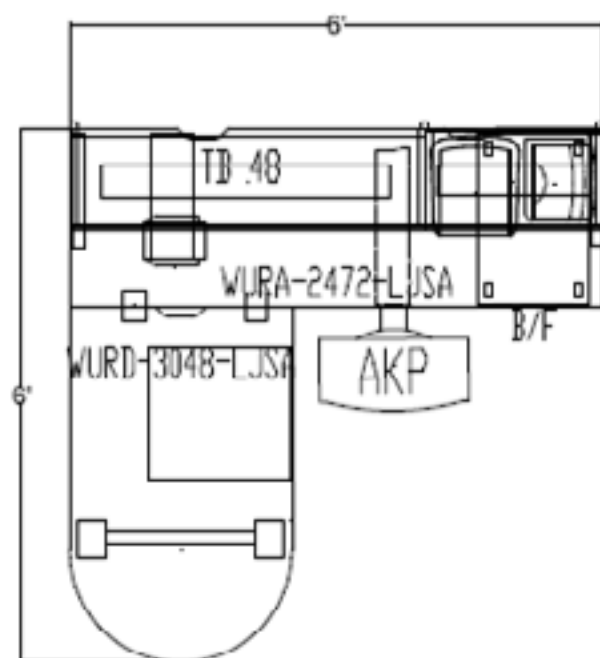
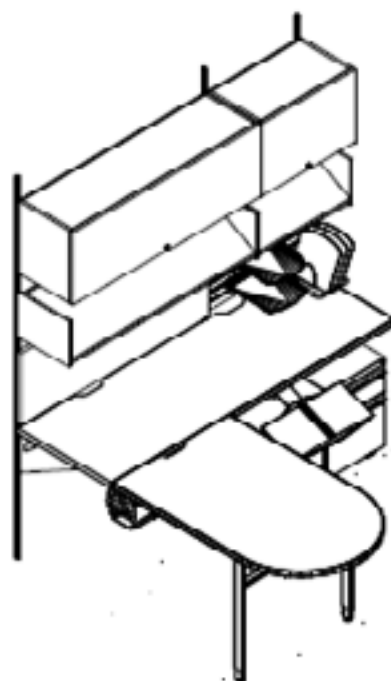

QTY	DESCRIPTION
3	Vertical Hanging Strips
2	Lockable Flipper Unit
2	Shelf, Storage/Display
2	Light
1	Tackboard
1	Slat Wall
2	Paper Tray
1	Diagonal Tray
1	Cantilevered Work Surface
1	Peninsula Work Surface
1	Adjustable Keyboard Tray
1	Mobile Pedestal, Box/File
1	Pencil Drawer
1	CPU Holder

Department of Defense

Administrative Typicals

E0063

E0066



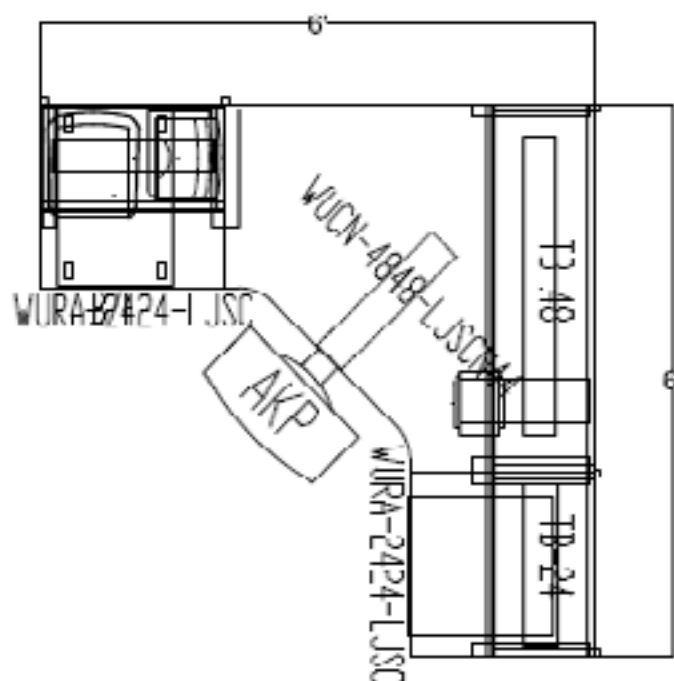
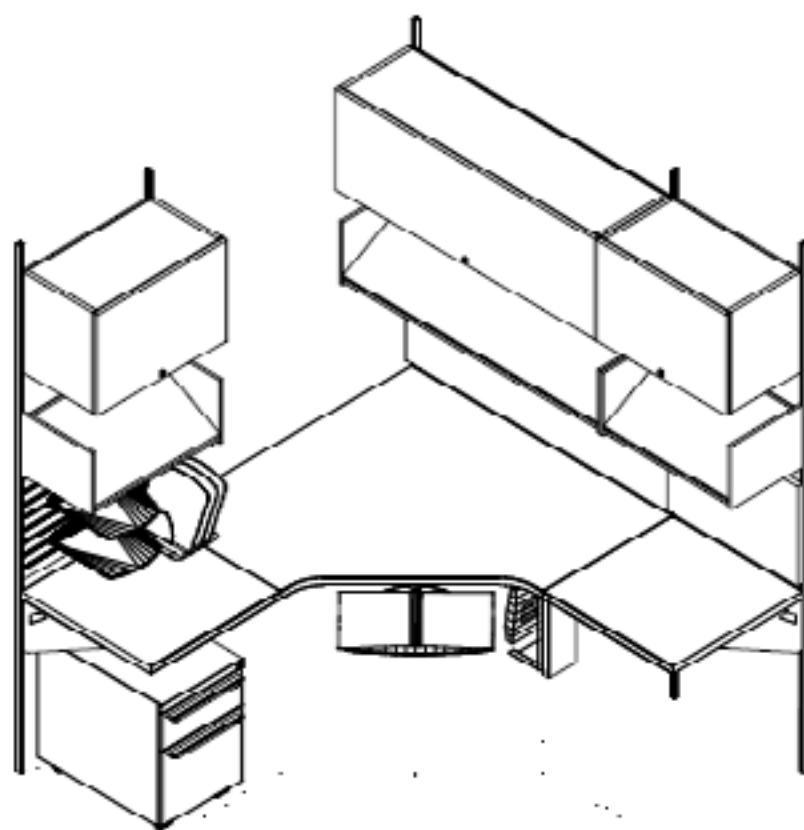

QTY	DESCRIPTION
5	Vertical Hanging Strips
3	Lockable Flipper Unit
3	Shelf, Storage/Display
3	Light
2	Tackboard
1	Slat Wall
2	Paper Tray
1	Diagonal Tray
2	Cantilevered Work Surface
1	Cantilevered Corner Work Surface
1	Mobile Pedestal, Box/File
1	Adjustable Keyboard Tray
1	Pencil Drawer
1	CPU Holder

Department of Defense

Administrative Typicals

E0066



E0069

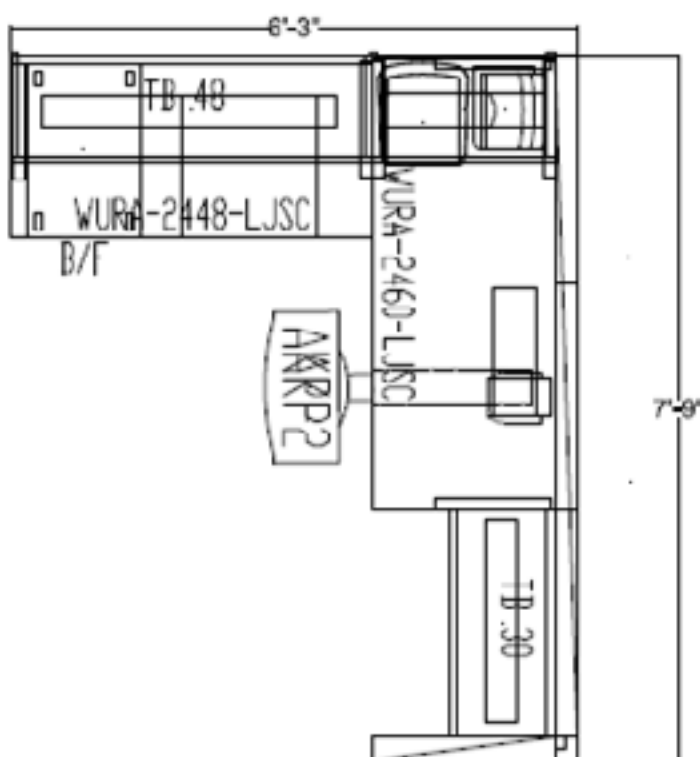
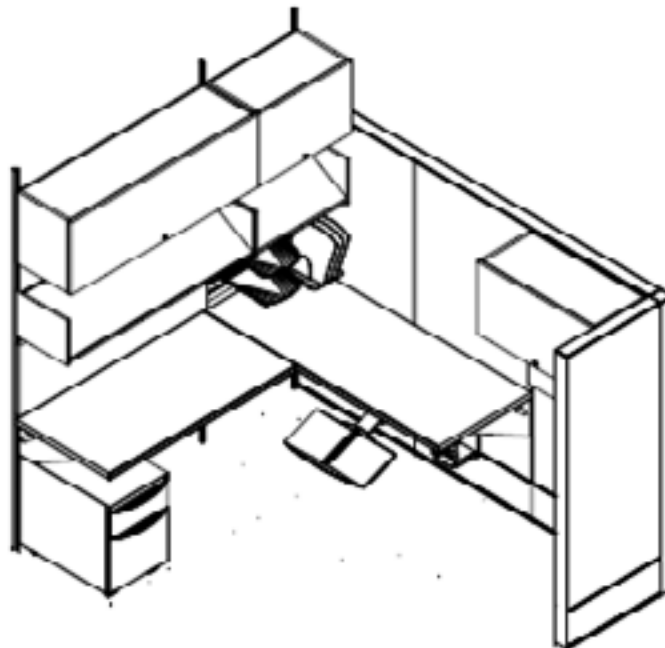

QTY	DESCRIPTION
3	Vertical Hanging Strips
4	Standard Solid Panel
2	Panel-to-Panel Connector
1	Panel Connector, 2-Way
1	Finished End Hardware
3	Lockable Flipper Unit
2	Shelf, Storage/Display
3	Light
2	Tackboard
1	Slat Wall
2	Paper Tray
1	Diagonal Tray
2	Cantilevered Work Surface
1	Adjustable Keyboard Tray
1	Mobile Pedestal, Box/File
1	Pencil Drawer
1	CPU Holder

Department of Defense

Administrative Typicals

E0069



E0072

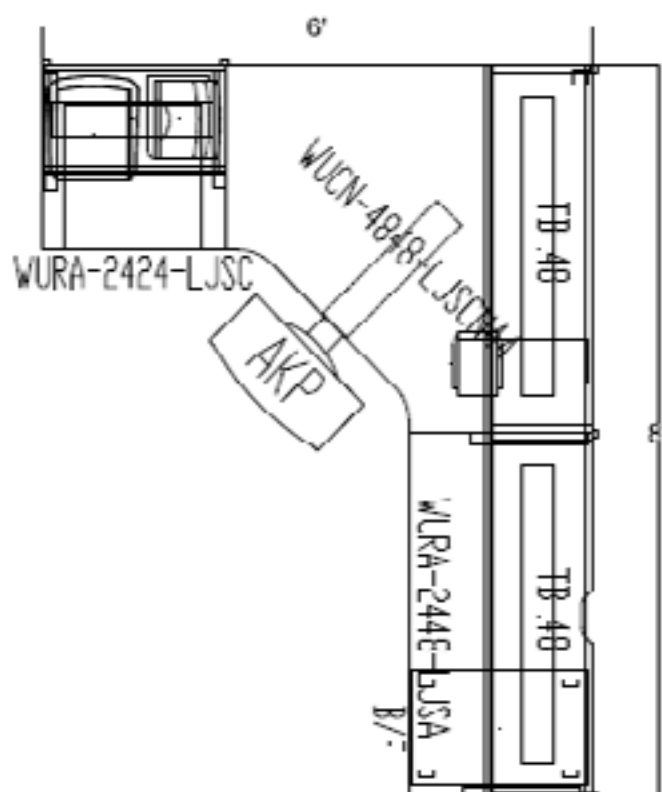
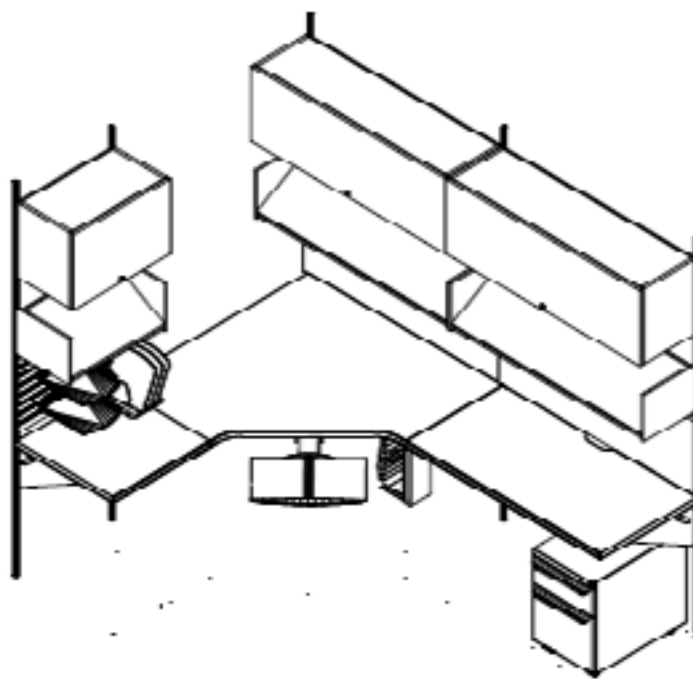

QTY	DESCRIPTION
5	Vertical Hanging Strips
3	Lockable Flipper Unit
3	Shelf, Storage/Display
3	Light
2	Tackboard
1	Slat Wall
2	Paper Tray
1	Diagonal Tray
2	Cantilevered Work Surface
1	Cantilevered Corner work Surface
1	Adjustable Keyboard Tray
1	Mobile Pedestal, Box/File
1	Pencil Drawer
1	CPU Holder

Department of Defense

Administrative Typicals

E0072



E0075

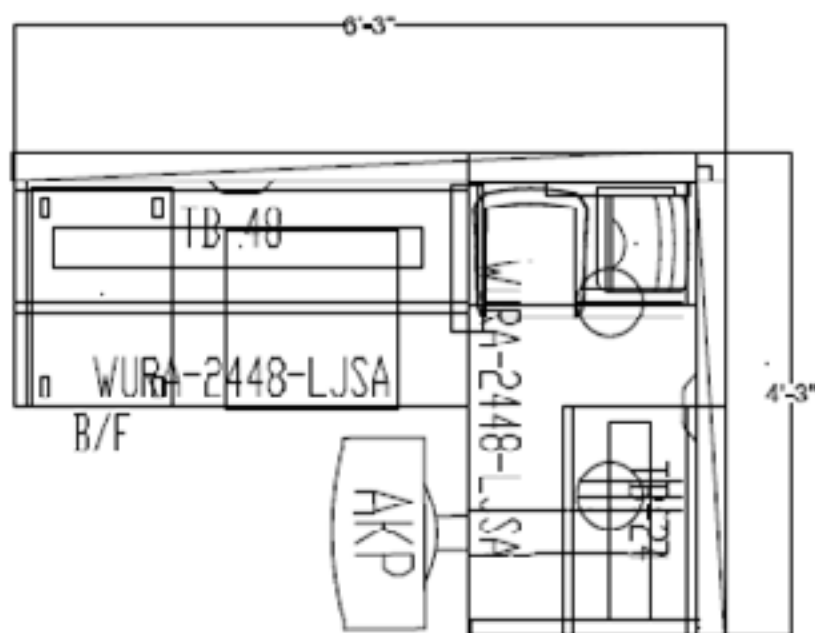
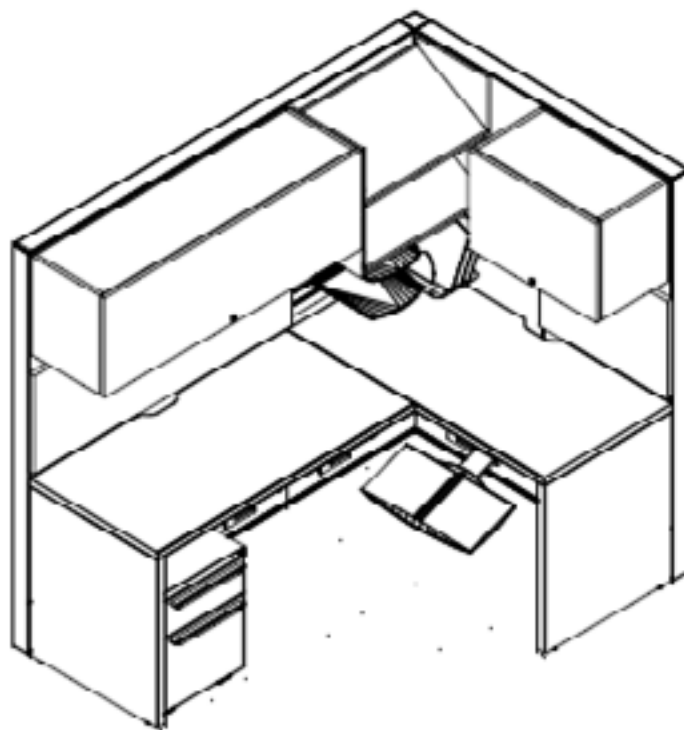

QTY	DESCRIPTION
4	Standard Solid Panel
2	Panel-to-Panel Connector
1	Panel Connector, 2-Way
2	Finished End Hardware
2	Lockable Flipper Unit
2	Shelf, Storage/Display
3	Light
2	Tackboard
1	Slat Wall
2	Paper Tray
1	Diagonal Tray
2	Cantilevered Work Surface
1	Adjustable Keyboard Tray
1	Mobile Pedestal, Box/File
1	Pencil Drawer
2	Support Panel

Department of Defense
Administrative Typicals

E0075



E0078

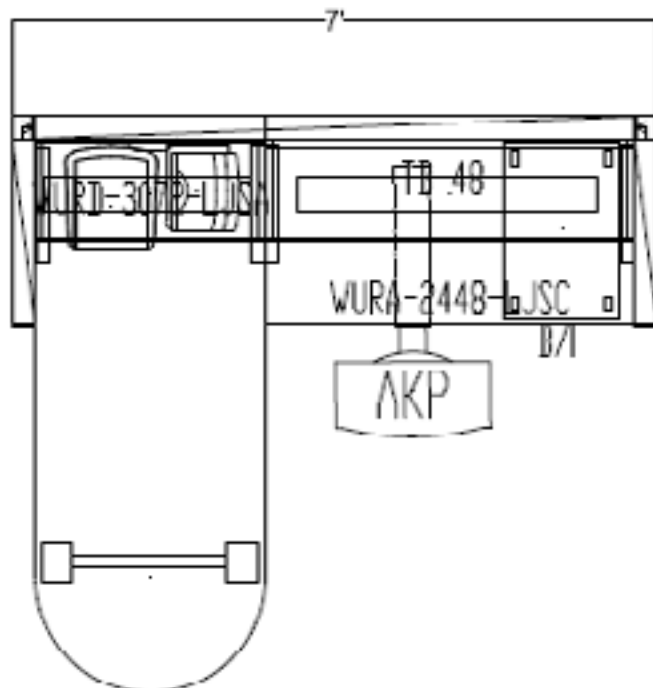
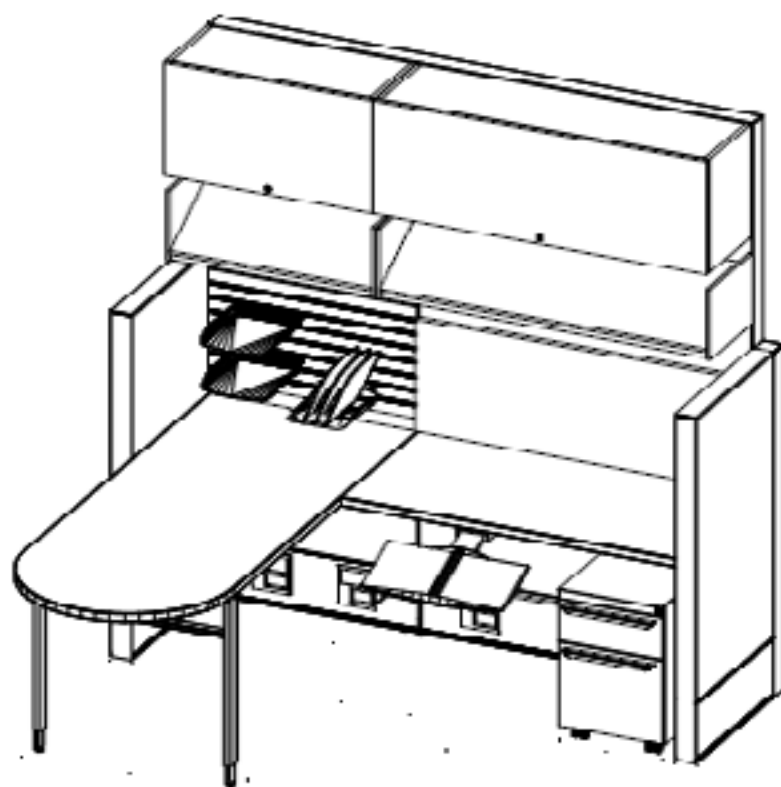

QTY	DESCRIPTION
4	Standard Solid Panels
2	Panel Connector, 2-Way Corner
1	Panel-to-Panel Connector
2	Finished End Hardware
1	Canilevered Work Surface
1	Peninsula Work Surface
2	Lockable Flipper Unit
2	Shelf, Storage/Display
2	Light
1	Tackboard
1	Slat Wall
1	Paper Tray
1	Diagonal Tray
1	Adjustable Keyboard Tray
1	Mobile Pedestal, Box/File

Department of Defense

Administrative Typicals

E0078



E0081

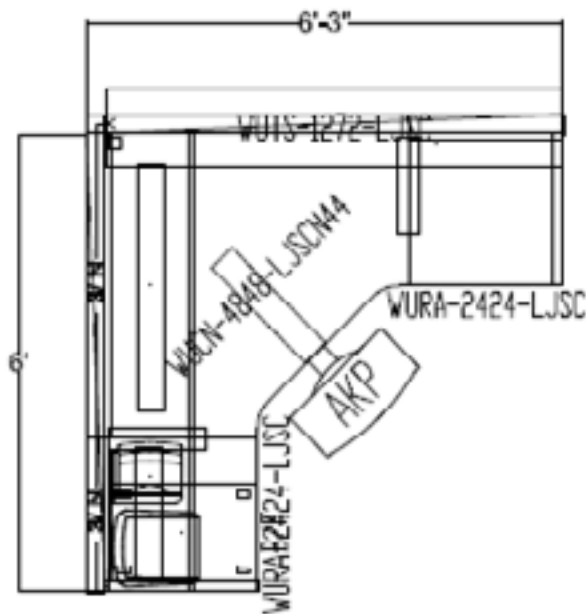
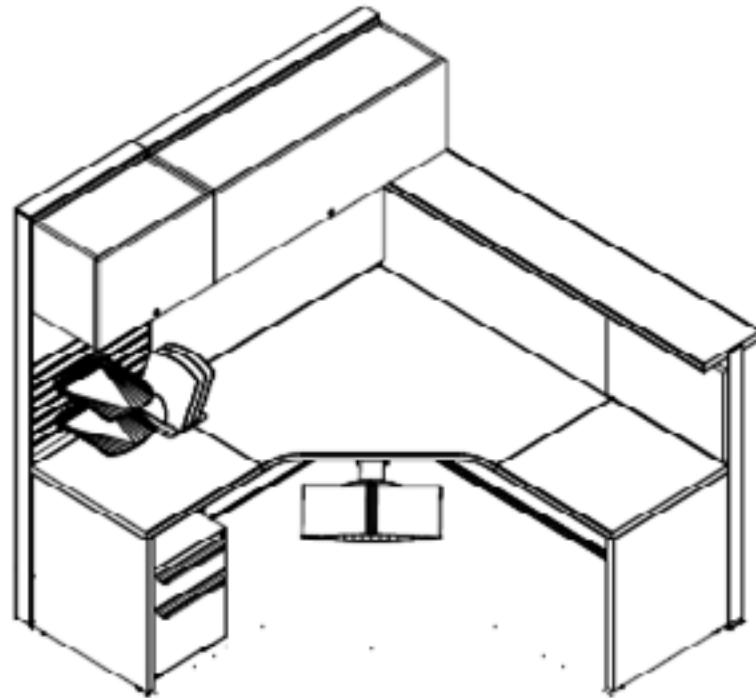

QTY	DESCRIPTION
4	Standard Solid Panel
2	Panel-to-Panel Connector
1	Panel Connector, 2-Way Corner
2	Finished End Hardware
1	Cantilevered, Corner Worksurface
2	Cantilevered Worksurface
1	Transaction Counter Top
2	Lockable Flipper Unit
2	Light
2	Tackboard
1	Slat Wall
2	Paper Tray
1	Diagonal Tray
2	Support Panel
1	Adjustable Keyboard Tray
1	Mobile Pedestal, Box/File

Department of Defense
Administrative Typicals

E0081



E0084

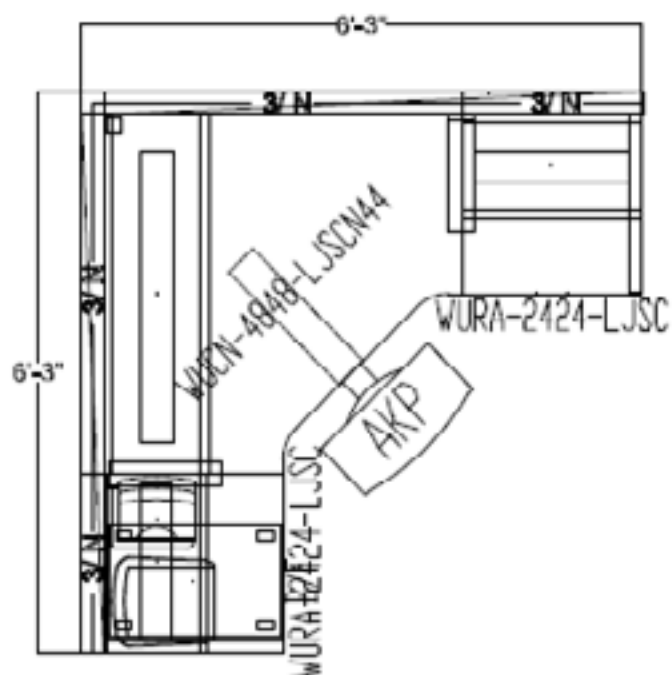
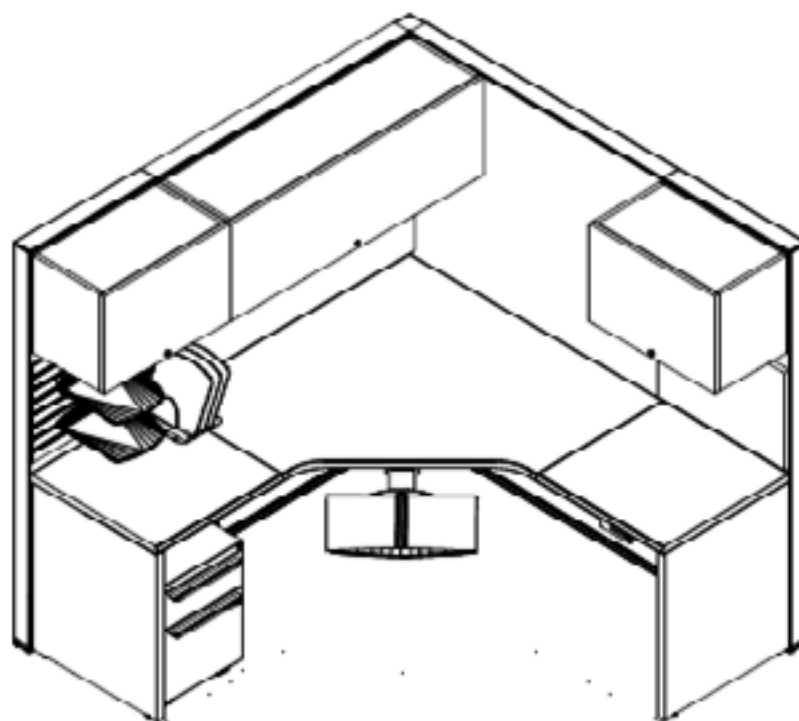

QTY	DESCRIPTION
4	Standard Solid Panel
2	Panel-to-Panel Connector
1	Panel Connector, 2-Way Corner
2	Finished end Hardware
3	Lockable Flipper Unit
3	Light
2	Tackboard
2	Slat Wall
2	Paper Tray
1	Diagonal Tray
2	Cantilevered Worksurface
1	Cantilevered Corner Worksurface
1	Adjustable Keyboard Tray
1	Mobile Pedestal, Box/File
1	Pencil Drawer
2	Support Panel

Department of Defense

Administrative Typicals

E0084



E0087

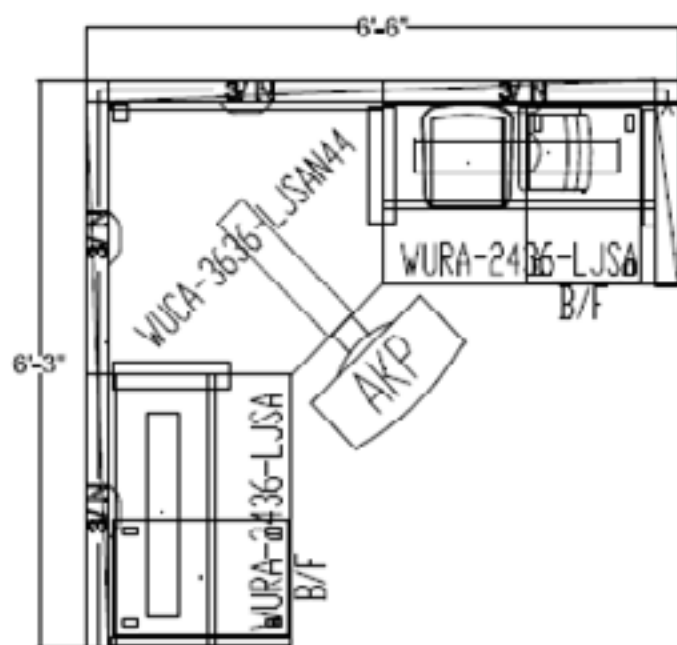
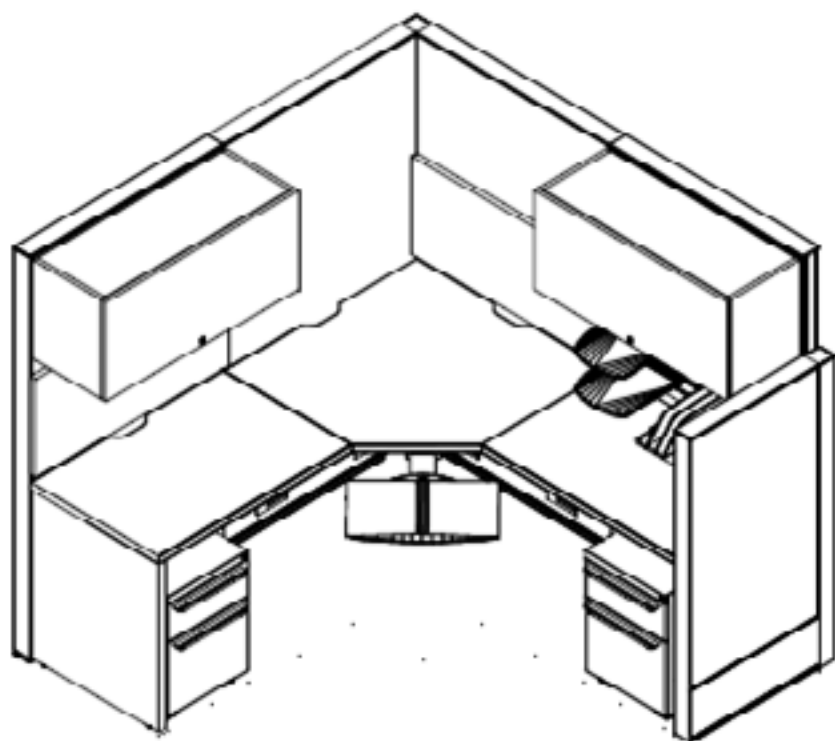

QTY	DESCRIPTION
5	Standard Solid Panel
2	Panel-to-Panel Connector
2	Panel Connector, 2-Way Corner
2	Finished End Hardware
1	Cantilevered, Corner Worksurface
2	Cantilevered, Worksurface
2	Lockable Flipper Unit
2	Light
2	Tackboard
1	Slat Wall
2	Paper Tray
1	Diagonal Tray
1	Adjustable Keyboard Tray
2	Mobile Pedestal, Box/File
1	Support Panel

Department of Defense

Administrative Typicals

E0087



E0090

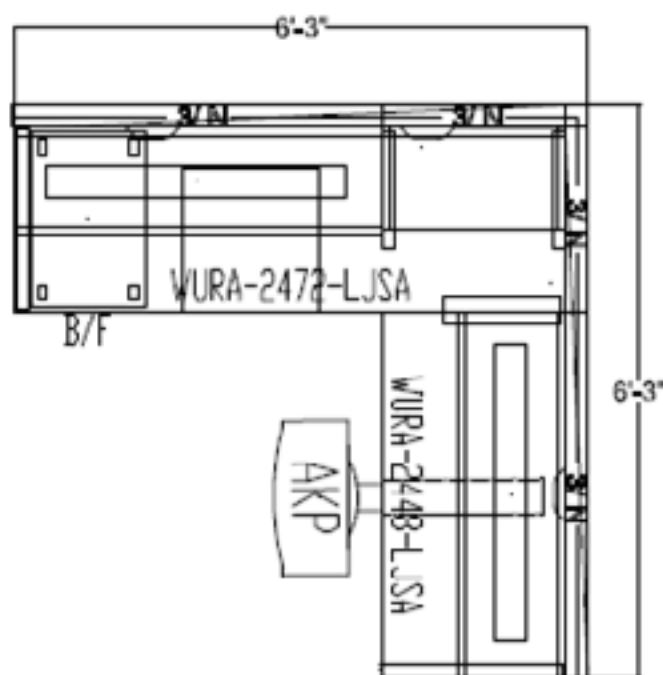
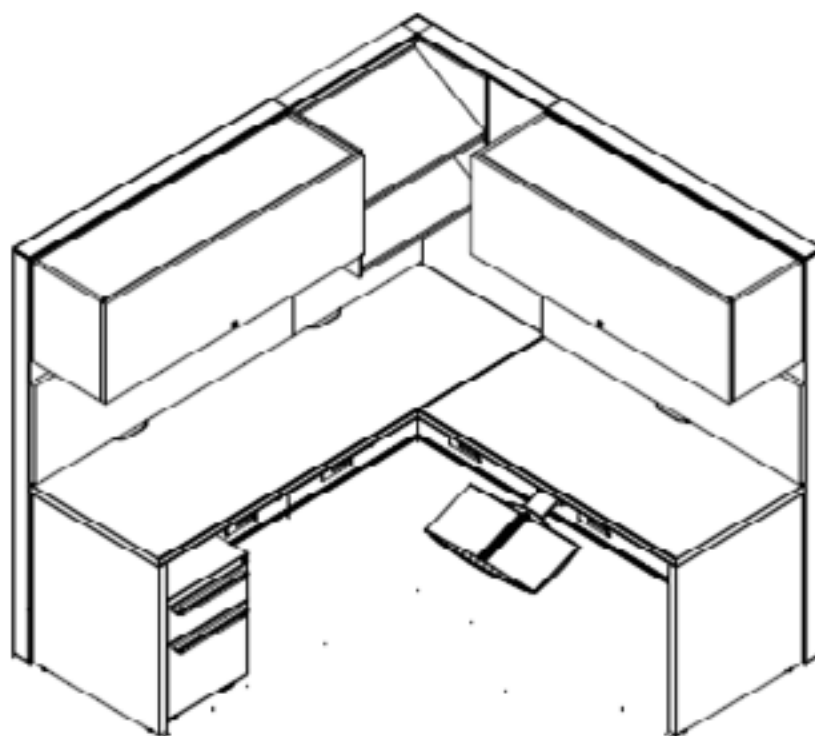

QTY	DESCRIPTION
4	Standard Solid Panel
2	Panel-to-Panel Connector
1	Panel Connector, 2-Way Corner
2	Finished End Hardware
2	Lockable Flipper Unit
2	Shelf, Storage/Display
3	Light
3	Tackboard
2	Cantilevered Worksurface
1	Adjustable Keyboard Tray
1	Mobile Pedestal, Box/File
1	Pencil Drawer
2	Support Panel

Department of Defense

Administrative Typicals

E0090

E0093



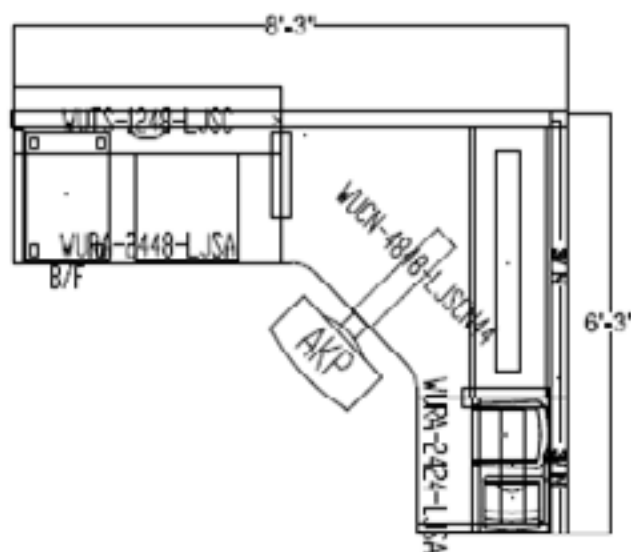
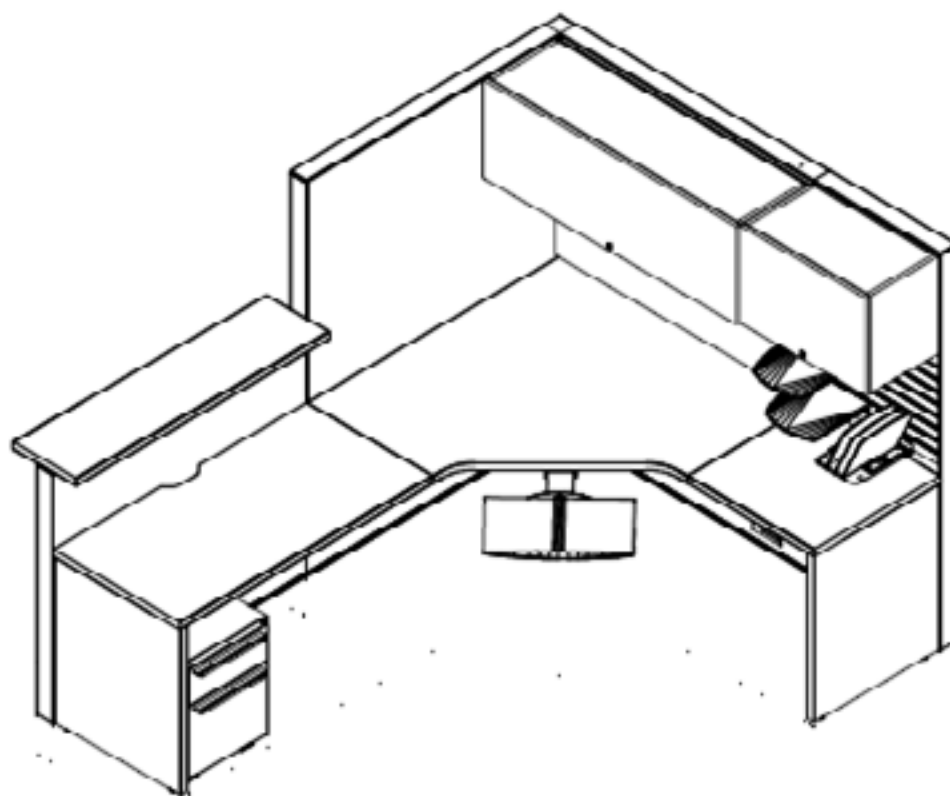

QTY	DESCRIPTION
4	Standard Solid Panel
2	Panel-to-Panel Connector
1	Panel Connector, 2-Way Corner
3	Finished End Hardware
2	Lockable Flipper Unit
2	Light
1	Tackboard
1	Slat Wall
2	Paper Tray
1	Diagonal Tray
2	Cantilevered Worksurface
1	Cantilevered, Corner Worksurface
1	Transaction Countertop
1	Adjustable Keyboard Tray
1	Mobile Pedestal, Box/File
1	Pencil Drawer
2	Support Panel

Department of Defense
Administrative Typicals

E0093

E0096



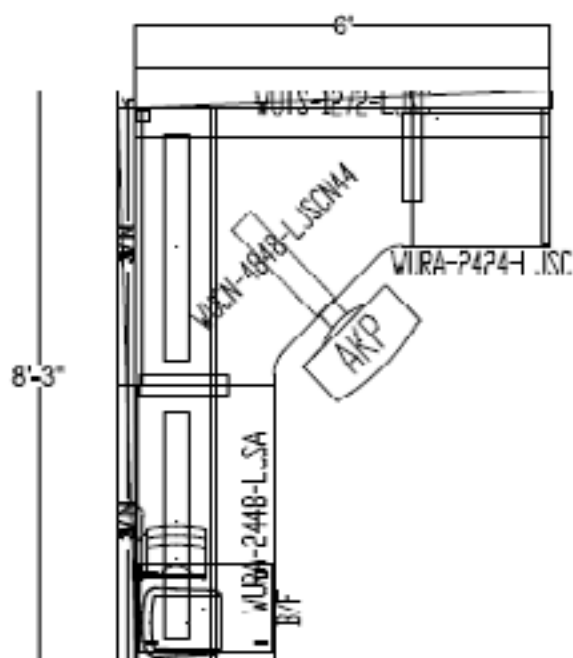
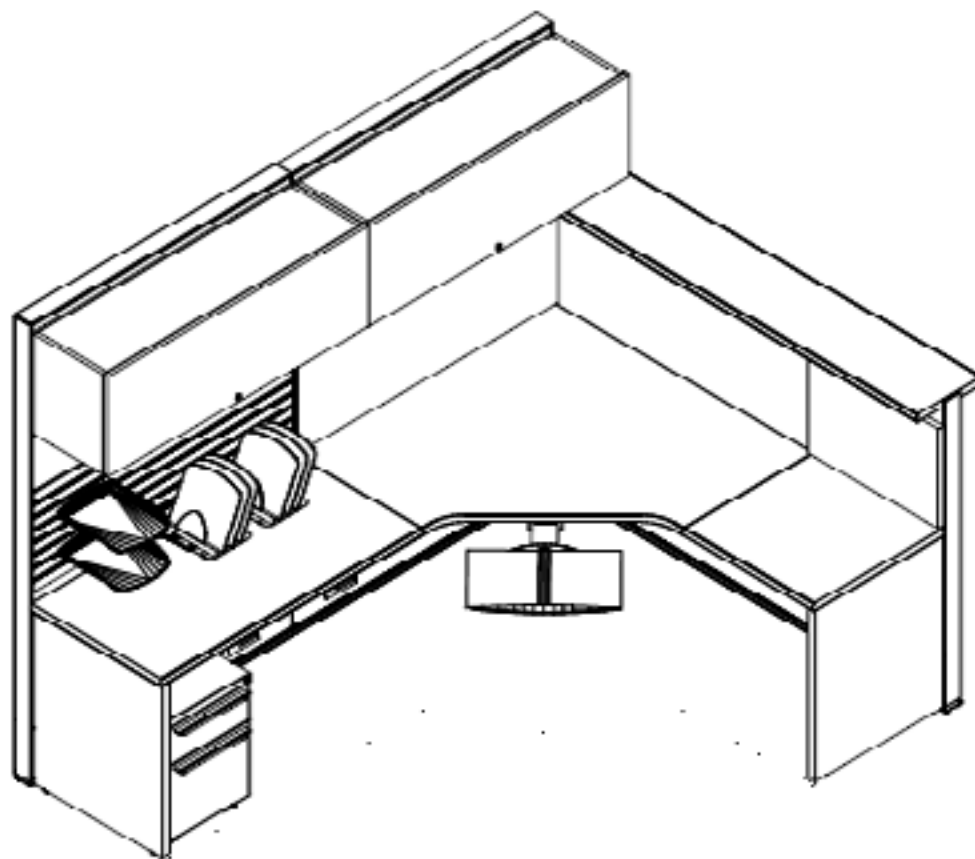

QTY	DESCRIPTION
4	Standard Solid Panel
2	Panel-to-Panel Connector
1	Panel Connector, 2-Way Corner
2	Finished End Hardware
1	Cantilevered Corner Worksurface
2	Cantilevered Worksurface
1	Transaction Counter Top
2	Lockable Flipper Unit
2	Light
2	Tackboard
1	Slat Wall
2	Paper Tray
2	Diagonal Tray
1	Mobile Pedestal, Box/File
1	Adjustable Keyboard Tray
2	Support Panel

E0099





E0102

(3) hanging files
should be here

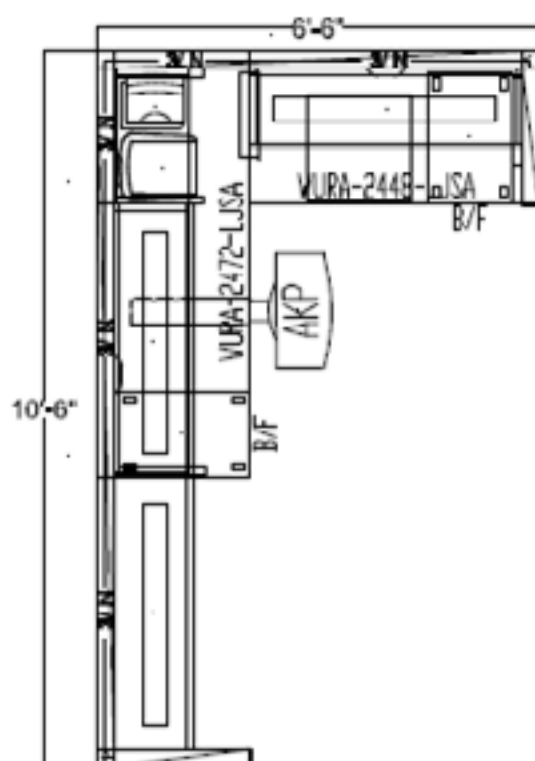
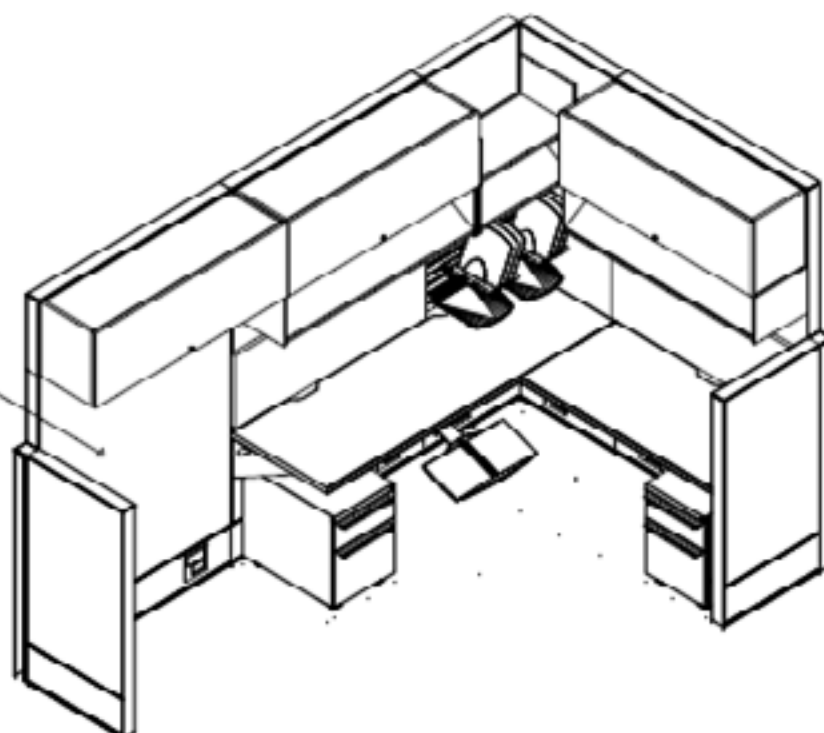

QTY	DESCRIPTION
7	Standard Solid Panel
3	Panel-to-Panel Connector
3	Panel Connector, 2-Way Corner
2	Finished End Hardware
2	Cantilevered Worksurface
3	Lockable Flipper Unit
1	Shelf
3	Shelf Storage/Display
3	Light
3	Hanging File Drawer
2	Tackboard
1	Slat Wall
2	Paper Tray
2	Diagonal Tray
2	Mobile Pedestal, Box/File
1	Adjustable Keyboard Tray
1	Pencil Drawer

Department of Defense
Administrative Typicals

E0102



E0105

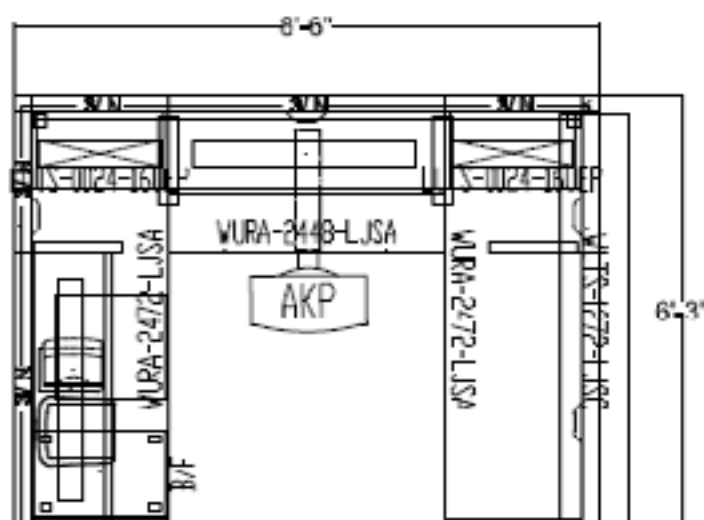
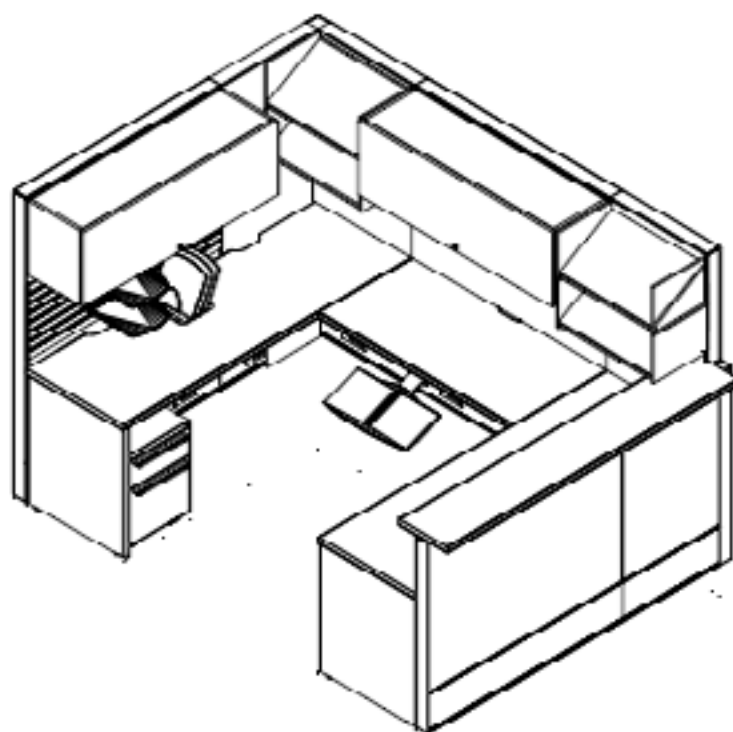

QTY	DESCRIPTION
7	Standard Solid Panel
4	Panel-to-Panel Connector
2	Panel Connector, 2-Way
3	Finished End Hardware
2	Lockable Flipper Unit
4	Shelf, Storage/Display
4	Light
3	Tackboard
1	Slat Wall
2	Paper Tray
1	Diagonal Tray
3	Canilevered Work Surface
1	Transaction Counter Top
1	Adjustable Keyboard Tray
1	Mobile Pedestal, Box/File
1	Pencil Drawer
2	Support Panel

Department of Defense

Administrative Typicals

E0105



E0108

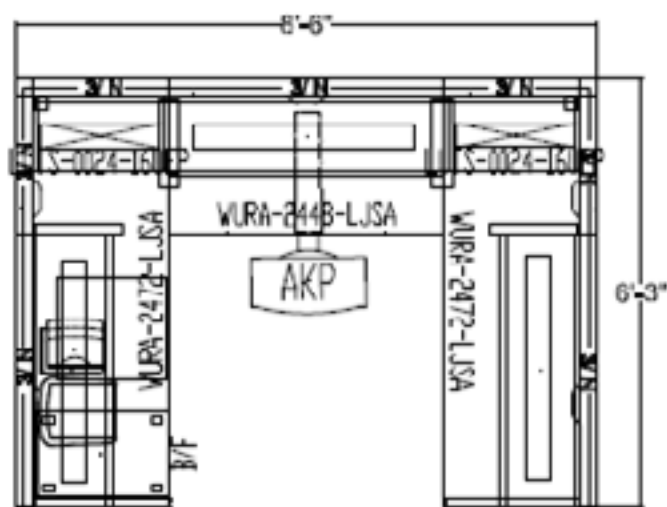
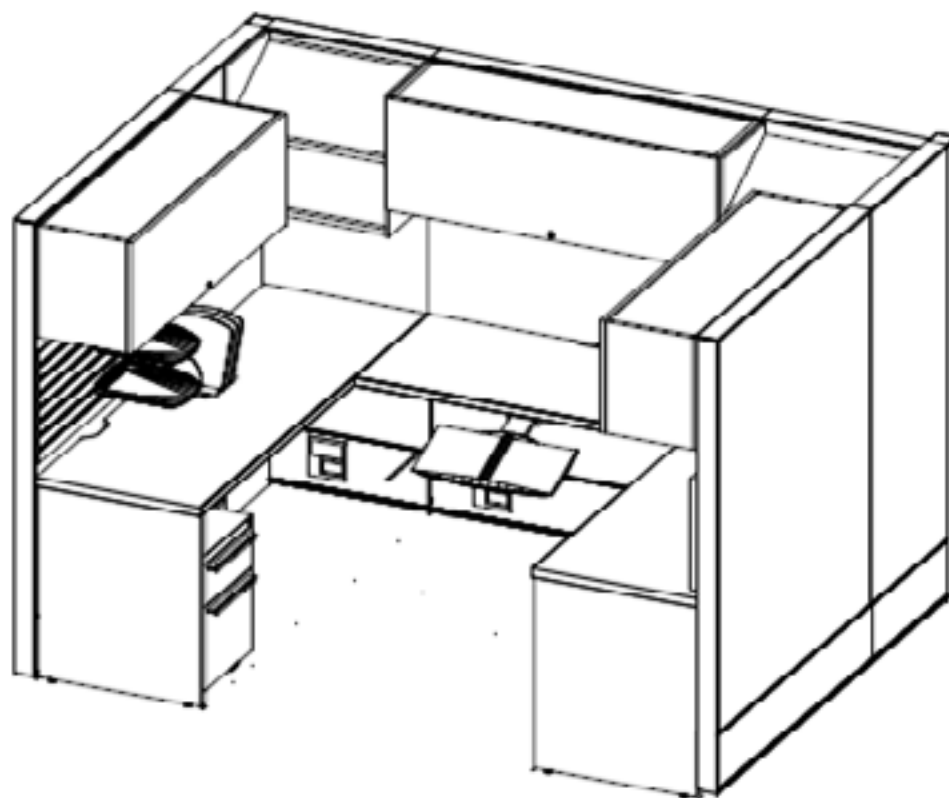

QTY	DESCRIPTION
7	Standard Solid Panel
4	Panel-to-Panel Connector
2	Panel Connector, 2-Way
2	Finished End Hardware
3	Lockable Flipper Unit
4	Shelf, Storage/Display
5	Light
4	Tackboard
1	Skat Wall
2	Paper Tray
1	Diagonal Tray
3	Cantilevered Worksurface
1	Adjustable Keyboard Tray
1	Mobile Pedestal, Box/File
1	Pencil Drawer
2	Support Panel

Department of Defense

Administrative Typicals

E0108



E0111

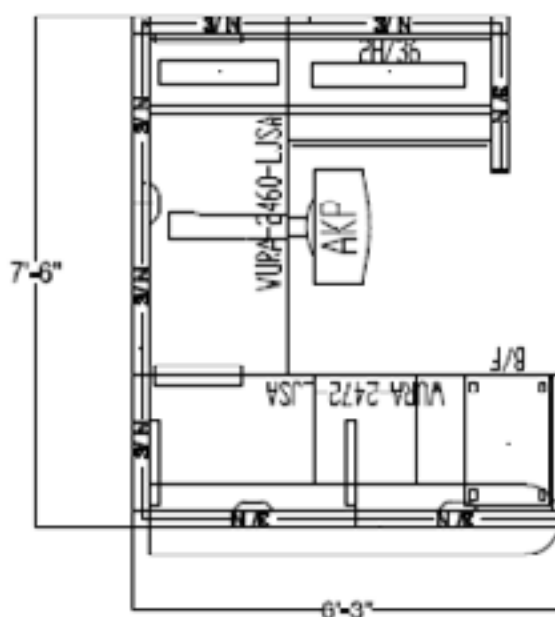
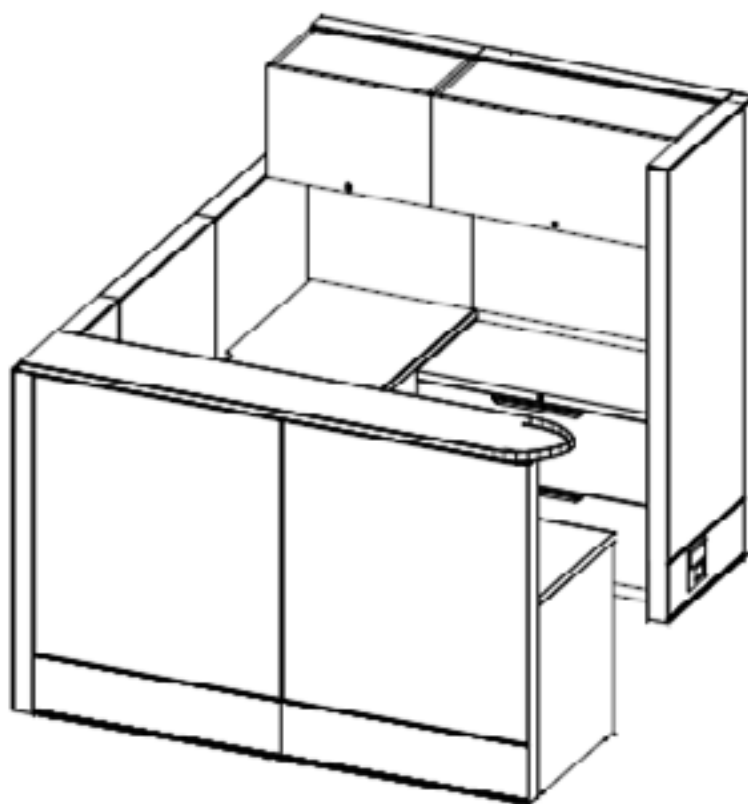

QTY	DESCRIPTION
8	Standard Solid Panel
4	Panel-to-Panel Connector
2	Panel Connector, 2-Way
2	Finished End Hardware
2	Lockable Flipper Unit
2	Light
2	Tackboard
2	Cantilevered Worksurface
1	Adjustable Keyboard Tray
1	Mobile Pedestal, Box/File
1	Pencil Drawer
1	Support Panel
1	2h 36"W Lateral File

Department of Defense

Administrative Typicals

E0111



E0114

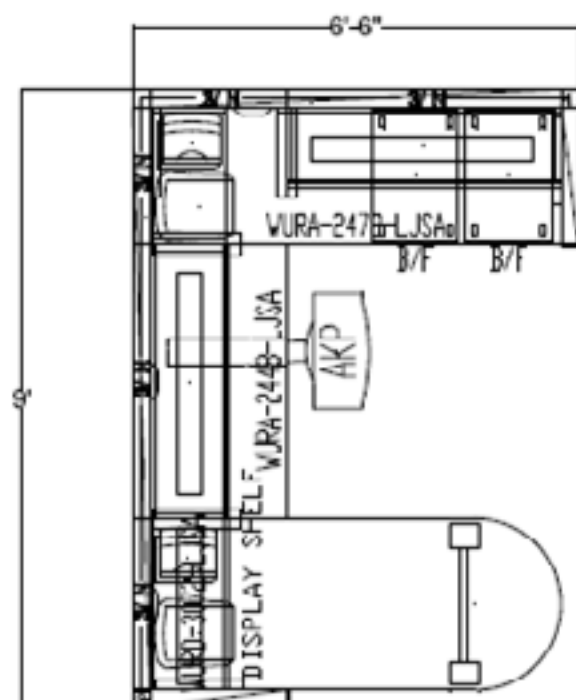
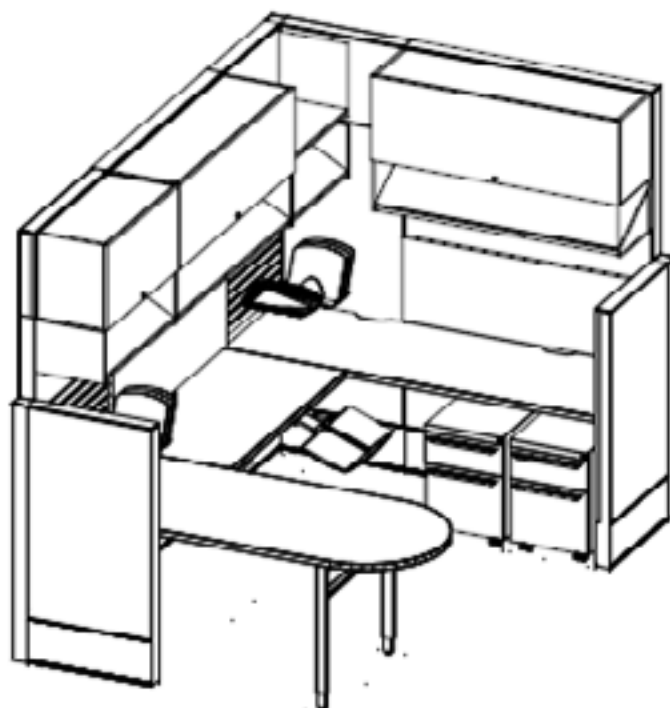

QTY	DESCRIPTION
7	Standard Solid Panel
3	Panel Connector, 2-Way
3	Panel-to-Panel Connector
2	Finished End Hardware
2	Cantilevered Worksurface
1	Peninsula Worksurface
3	Lockable Flipper Unit
1	Shelf
4	Shelf, Storage/Display
4	Light
2	Tackboard
2	Slat Wall
2	Paper Tray
2	Diagonal Tray
1	Adjustable Keyboard Tray
2	Mobile Pedestal, Box/File

Department of Defense

Administrative Typicals

E0114



E0117

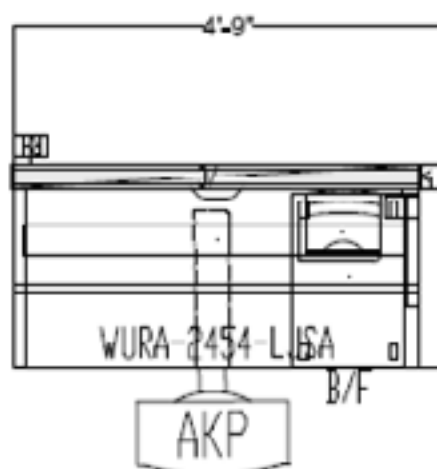
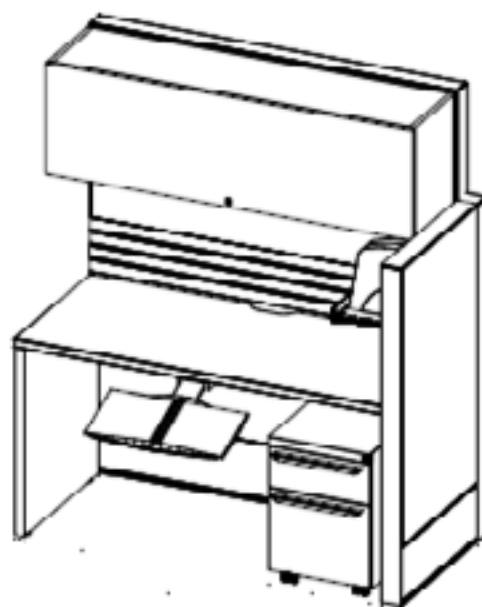

QTY	DESCRIPTION
2	Standard Solid Panel
1	Panel Connector, 2-Way
2	Finished End Hardware
1	Cantilevered Worksurface
1	Lockable Flipper Unit
1	Light
1	Tackboard
1	Slat Wall
1	Diagonal Tray
1	Adjustable Keyboard Tray
1	Mobile Pedestal, Box/File
1	Support Panel

Department of Defense

Administrative Typicals

E0117



E0120

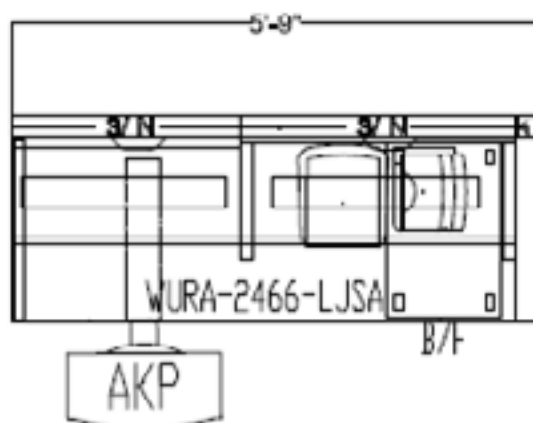
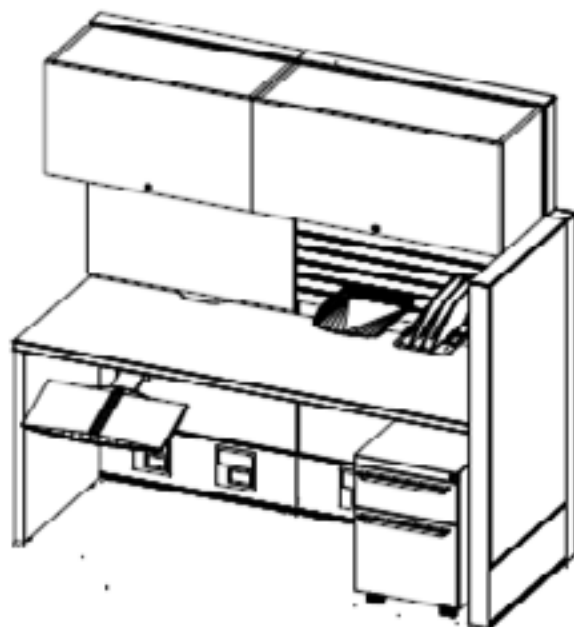

QTY	DESCRIPTION
3	Standard Solid Panel
1	Panel-to-Panel Connector
1	Panel Connector, 2-Way
2	Finished End Hardware
1	Cantilevered Worksurface
2	Lockable Flipper Unit
2	Light
1	Tackboard
1	Slat Wall
1	Paper Tray
1	Diagonal Tray
1	Adjustable Keyboard Tray
1	Mobile Pedestal, Box/File
1	Support Panel

Department of Defense

Administrative Typicals

E0120



E0123

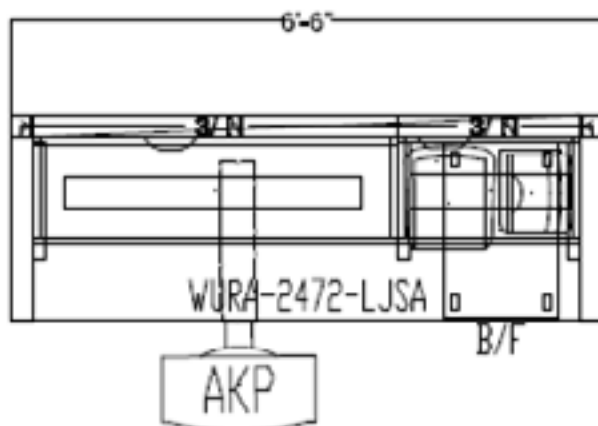
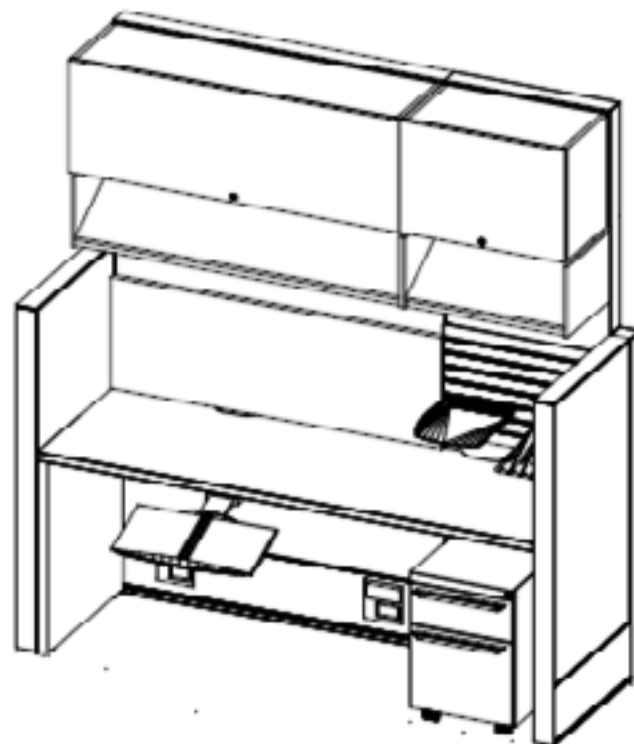

QTY	DESCRIPTION
4	Standard Solid Panel
2	Panel Connector, 2-Way
1	Panel-to-Panel Connector
2	Finished End Hardware
1	Cantilevered Worksurface
2	Lockable Flipper Unit
2	Shelf, Storage/Display
2	Light
1	Tackboard
1	Slat Wall
1	Paper Tray
1	Diagonal Tray
1	Adjustable Keyboard Tray
1	Mobile Pedestal, Box/File

Department of Defense
Administrative Typicals

E0123

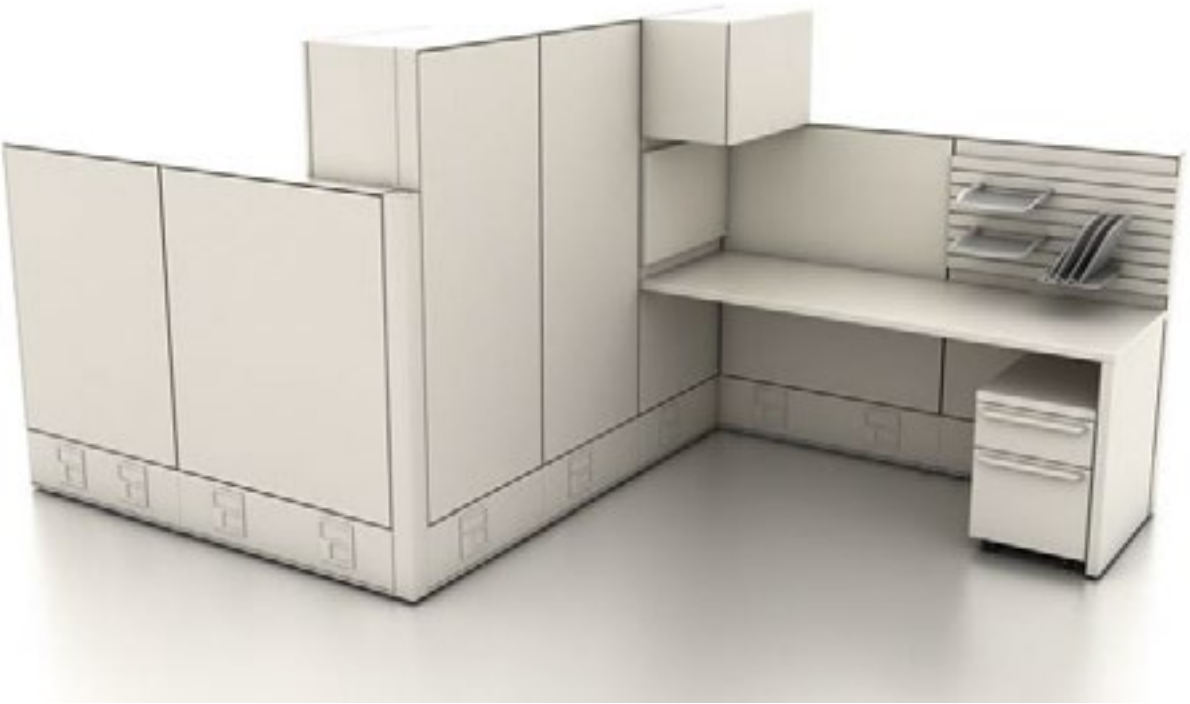

E0126

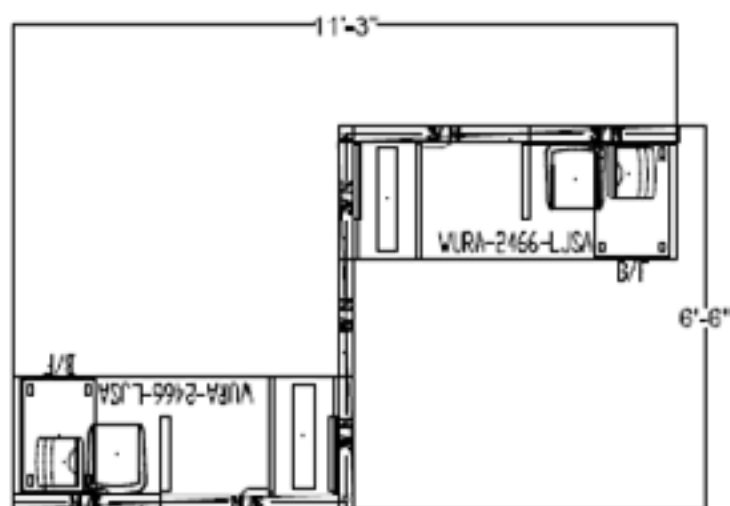
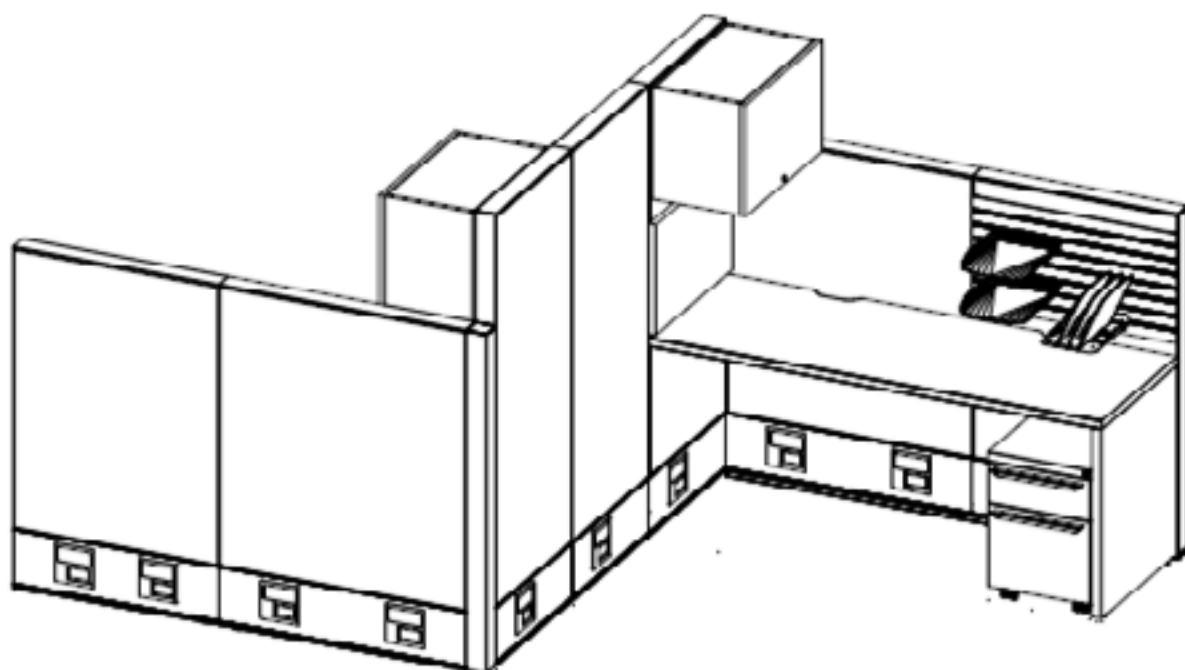

QTY	DESCRIPTION
7	Standard Solid Panel
4	Panel-to-Panel Connector
2	Panel Connector, 2-Way
2	Finished End Hardware
2	Lockable Flipper Unit
2	Light
2	Tackboard
2	Slat Wall
4	Paper Tray
2	Diagonal Tray
2	Cantilevered Worksurface
2	Mobile Pedestal, Box/File
2	Support Panel

Department of Defense

Administrative Typicals

E0126